

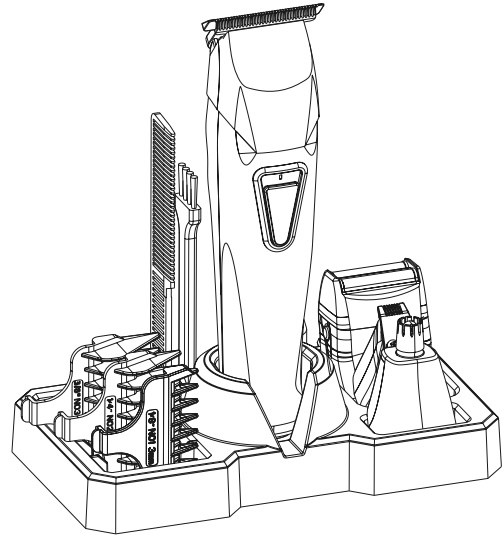

WahlUSA.com

# GROOMSMAN T-PRO™



## Operating Instructions for The All-In-One Grooming Kit Instrucciones de operación de la recortadora recargable

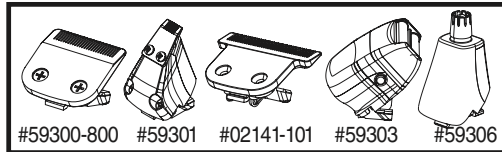

The trimmer you purchased may not have all of these heads, but they will all work with your trimmer if you wish to purchase them. You may order additional heads online at WahlUSA.com.

■ **Self-sharpening blades** are high compression, high-carbon steel, made to maintain their shape and sharpness for extended periods.

### NOW YOU CAN KEEP ON SHAVING WHILE CLEANING UP INGROWN WHISKERS

Men with very curly facial hair have a special problem with shaving. Specifically, ingrown whiskers. Their whiskers curl back toward the skin — and grow in many different directions. Electric razors can't pick them up through their slotted or mesh heads. And safety razors slice them off at a sharp angle. Either way, the stubble is left in an ideal condition to cause ingrown hair problems. Continued shaving over the bumps and irritated skin, of course, makes the condition worse.

But you don't have to stop shaving altogether. With this Wahl trimmer and its specially designed T-blade, you can maintain a neat, shaved appearance while getting help with ingrown whiskers. Its open-tooth comb action picks up and straightens curly whiskers for cutting — while its high-speed blades move across at a flat angle to the whiskers, clipping them off evenly.

### SHAVING WITH THE T-BLADE

#### Wash Up

1. Make sure your hands and fingernails are scrubbed as clean as possible before touching your face. Irritated skin is very easily infected by germs.

### 5-YEAR LIMITED WARRANTY

Valid in U.S.A. Only

If your Wahl product fails to operate satisfactorily within five (5) years from the date of original purchase or receipt as a gift, Wahl will, at our option, repair or replace it and return it to you FREE OF CHARGE. **Do not return this product to store where purchased.** Products needing repair under this warranty should be returned with postage prepaid to:

**Wahl Clipper Corp.  
Attn: Repair Department  
3001 Locust Street  
Sterling, Illinois 61081**

Include a note describing the defect and the date of original purchase or receipt as a gift (if in warranty). Products out of warranty will be repaired at our standard repair charges. This warranty is void and no repair or replacement will be made under this warranty or otherwise if: (1) The product is modified in any manner or repaired by anyone other than Wahl Clipper Corporation or Wahl authorized service center. (2) The product has been used commercially or subjected to unreasonable use. This warranty gives you specific legal rights and you may also have other rights which may vary from state to state. No other written express warranty is given. Any implied warranty, including any warranty of merchantability which may arise from purchase or use, is limited to the year period provided in this express warranty. Some states may not allow such limitation, so it may not apply to you. No responsibility is assumed for incidental or consequential damages of any type, or for the use of unauthorized attachments. Some states may not allow the exclusion or limitation of incidental or consequential damages, so the limitation or exclusion may not apply to you. Outside U.S.A., check with store for Wahl authorized distributor's warranty.

For more information or Product Registration, visit [WahlUSA.com](http://WahlUSA.com)

© 2018 Wahl Clipper Corporation  
Part No. 94489-001  
Printed in U.S.A.

# SAVE THESE INSTRUCTIONS For Household Use Only RECHARGING

1. This trimmer is conveniently designed for household use. It should be allowed to charge overnight before first use.
2. Remove the trimmer, recharging transformer and accessories from the packing material.
3. Connect the transformer to the trimmer. BE SURE TRIMMER IS IN THE "OFF - 0" POSITION WHEN CHARGING.
4. Plug the recharging transformer into any convenient electrical outlet at the correct voltage.
5. When trimmer is low in power, it should be connected to the transformer and plugged into an outlet to assure maximum power is available when it is next used. This transformer is designed to continuously charge the battery without overcharging.
6. Ni-MH battery life may be extended with the following procedure: Once every month, let the trimmer run until the motor stops. Move the switch to the "OFF - 0" position and recharge fully overnight.
7. Insert only recharging transformer plug supplied by the manufacturer into charger receptacle.

### TROUBLESHOOTING

If your trimmer does not seem to take a charge, check the following before returning it for repair:

1. Check outlet to make sure it is working by plugging in another appliance.
2. Make sure the outlet simply is not connected to a light switch which turns the power at the outlet off when lights are turned off.

### brushing. MUSTACHE TRIMMING

1. **Comb your mustache.** Looking into a well-lit mirror, comb your mustache in the direction that it grows. This will help reveal stray hairs and achieve an even, balanced trim.
2. **Cut the outline of your mustache.** Holding the trimmer in a vertical position, with the nameplate side facing you, define the line of your mustache. The extended tips on the blades let you achieve a clean, well-defined mustache line.
3. **Defining.** As a finishing step, hold the trimmer with the nameplate facing you. Using only the bare blades, make a definitive line at the bottom of your mustache.
4. **Tapering.** Hold the trimmer with the nameplate facing away from you. Again starting with the middle of your mustache, follow the lip line and taper out the mustache until a gentle shape is created on the bottom portion of your mustache.
5. **Defining.** As a finishing step, hold the trimmer with nameplate facing make a definitive line at the bottom of your mustache.

### TRIMMING AND EDGING YOUR BEARD

The following are suggested trimming steps and trimmer positions. You may find different procedures work better for you.

1. Comb your beard in the direction that it grows to help reveal stray hairs that may be longer than the others.
2. Attach the longest trimming guard to trim and taper your beard. Start at each sideburn and stroke downward toward your neck. Trim toward your chin in smooth, overlapping strokes, following the lay of your beard. If you trim against the way your beard naturally lays, the trimmer will cut the hair much shorter and the result may be patchy. Use to progressively shorter trimming guides until you reach the desired length of beard. You may wish to use the shortest trimming guard attachment to cut closer near the ear and down under the chin, changing to a longer trimming guide toward the front of the face and point of your chin. Always be sure the

3. Be sure the trimmer is properly connected to the recharging transformer, all connections are secure and the switch on the trimmer is turned "OFF - 0."
4. If your electricity is connected to a master power switch, we suggest the trimmer be disconnected from the charger anytime the master switch is off. Leaving the unit plugged into a dead outlet or an unplugged charger will drain the battery.
5. If trimmer does not run and it is completely charged, turn the unit "ON - I" and pinch or push the blades manually. (Oil may have dried out between the blades, so they may be temporarily stuck together.)

### BATTERY REMOVAL AND DISPOSAL

Under normal use, the rechargeable Ni-MH battery in your trimmer will last from three to five years. At the end of its life, when it will no longer take a full charge, the Ni-MH battery must be removed and recycled or disposed of properly. Do not attempt to replace the battery. All servicing or battery replacement should be performed by an Authorized WAHL Service Location. To remove the battery for recycling or disposal, follow these steps:

1. Make sure the on/off switch is in the "0" (OFF) position and that the cord is NOT plugged into the trimmer or any electrical outlet.
2. Cut open rubberized grip pad.
3. Pry the trimmer housing apart.
4. Locate circuit board and battery.
5. Pry battery off of circuit board.
6. Apply tape to both ends of the battery before recycling or properly disposing of it.
7. Discard the entire clipper.

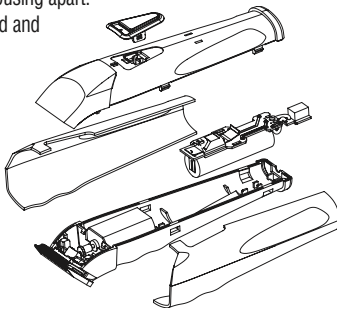

- trimming guard is locked solidly into the desired position before you start to trim.
3. To cut the outline of your beard, remove the trimming guard. Starting under your chin and working back toward your jawbone and ears, cut the outer perimeter of your beard underneath the jawbone. Continue the line all the way up to the ears and hairline.
4. Accentuate your beard line by using the trimmer in a downward motion. Start at the line you've created and, working from the chin back toward the ears, trim the area right under your beard line.
5. Define the upper part of your beard using the same technique.

### USE YOUR WAHL TRIMMER ON HAIR, TOO

That's part of its job. You can use it to keep expensive hairstyles trimmed—shaping hairlines, fading defining parts and trimming around neck and ears. You can use it to style hair, too, if you wish. To trim or style hair, first shampoo and dry hair thoroughly. Holding the Wahl trimmer with toothed edge pointed down, trim off a little at a time, carefully. It may be best to have someone else help you.

Your trimmer comes with three blade guards: #1, #2, and #3. For fading, use the attachment you desire; #1 for shortest length, #2 for medium length, and #3 for longest length. Attach the guard to the trimmer, making sure it is secure. Hold trimmer toward the temple line; begin to cut hair in an upward motion, staying below temple line for high, tight fades. For high, tight fade or military style fades, use the trimmer with a guard. Cut hair past temple line, working your way around the head from one side to the other. For blending techniques, use #2 and #3 guards to remove bulky hairline. Eventually, you should develop the skills to stay well groomed by a quick trim around neck, ears and sideburns.

### FADE CUT

1. Start at the temple and cut all the way around the head to establish the ultimate location of the fade line. Always cut against

### CARING FOR YOUR TRIMMER OILING BLADES

For best results, use Wahl Clipper Oil on the blades only when necessary, or approximately once a month. Motor bearings are permanently lubricated—do not attempt to oil.

When oiling your trimmer, turn the trimmer "ON - I," hold the unit with the blades facing DOWN and squeeze three drops across the front of the blade and one drop on each side on the heel of the blade. Wipe off excess oil with soft cloth.

### NOTICE—DO NOT OVER OIL!

Excessive oiling or application of liquids will cause damage if allowed to seep back into motor.

### BLADE CARE

Trimmer blades have precision-hardened, ground and lapped cutting teeth. Blades should be handled carefully and never bumped or used to cut dirty or abrasive material. Never rinse the blades with water, or the blades may rust. Clean with the included brush.

### CLEANING/STORAGE

Before storing your trimmer, use the cleaning brush to whisk any loose hairs from the unit and the blades. For units with a soft-touch grip, use a damp cloth to wipe down the body of the trimmer, taking care not to get the blades wet. Store unit in such a manner so that blades are protected from damage.

When the trimmer is not in use, the trimmer blade guard attachment should be in place to protect the blades.

This appliance should be stored in a manner where it is not subjected to crushing, heating above 100°C (212°F), or incineration.

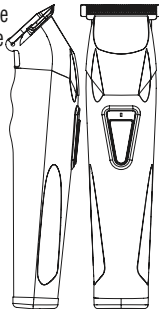
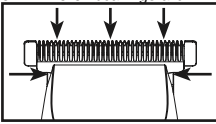

### SPECIAL FEATURES:

Your trimmer has been designed with several advanced features to help you get perfect results every time you trim. Your trimmer may be used to neatly trim goatees, beards, mustaches, neckline, sideburns around the ears and eyebrows, or anywhere you may need grooming. It also makes a great all-around family trimmer for mini haircuts and touch ups between trips to the barber or to clean up the shape of the neck.

■ **Soft-Touch Grip** allows you to hold the trimmer in a comfortable position for precision trimming.

■ **A Detachable Blade System** enables you to quickly change from a standard-width blade for full grooming to a narrow-width blade for detail trimming around a mustache, goatee, or anywhere to define the hair line and clip any stray whiskers.

To remove attachment, simply pull top edge of blade away from body unit. To attach, align back tab of attachment head to cavity on the inner edge of trimmer unit and push down on top of blade.

Should blades become damaged or dull or if you want additional attachment heads for your trimmer, you may purchase them from Wahl. It is also possible to purchase other heads for your groomer. Be sure to ask for the following attachment with part number from our service and repair department (see last page for contact information):

#### Attachment Head:Wahl Part Number

- Trimmer: #59300-800
- Detailer: #59301 (Included)
- T-Blade: #02141-101 (Included)
- Shaver: #59303 (Included)
- Rotary: #59306 (Included)

WahlUSA.com



### T-BLADE GUARDS:

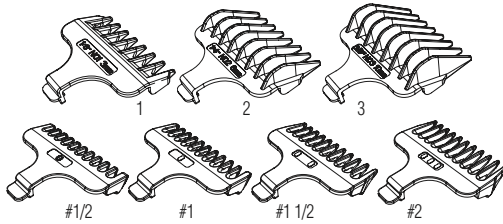

The trimmer you purchased may not have all of these guards, but they will all work with your trimmer if you wish to purchase them.

### USING GUARDS:

To attach guards, hold with the teeth up. Snap guard firmly to the bottom of the blade.

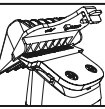

### SERVICE AND REPAIR

If you have problems with your trimmer, send it prepaid with a note explaining the problem to:

Wahl Clipper Corporation  
Attn: Repair Department  
3001 Locust Street  
Sterling, IL 61081  
Telephone (800) 767-9245

For products purchased outside the United States, contact your distributor.

### 60 Day Money Back Guarantee!

If for any reason within 60 days of purchase of your Wahl® trimmer you are not satisfied with your trimmer and would like a refund, just return your trimmer, together with the sales receipt, to the retailer from whom you purchased it. Wahl will reimburse all retailers who accept trimmers within 60 days of purchase. If you have any questions regarding this money-back guarantee, please call 1-800-767-9245 in the United States.

